

Direct Burial Installation Instructions*

Performed direct burial installation tips and directions

For all saw-cut applications use **BD Loops** preformed 3/16" saw-cut loop.

Installation in Concrete

See Reverse side of this page.
(Pictures included)

Installation Under Pavers

If the sub-base is concrete or a slurry do not use this loop. Saw-Cut in a loop instead.

Determine loop position and footprint to include lead-in run to gate operator. Be sure to use the correct loop size.*

Dig a 2" wide by 3-4" deep trench in the pattern of the loop and lead-in. (See Figure 1)

Fill Trench with one inch of sand.

Place loop in trench and run lead-in through 1/2" schedule 40 or 80 rigid PVC. Glue all PVC joints. If you have a gopher problem lead-in can be run in metallic conduit.

Cover loop and lead-in PVC run with 2 1/2" of sand.

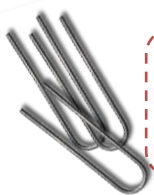

The ground stakes included with the loop are to help hold the loop down while laying out a trench pattern. When the loop is placed in the trench the ground stakes are no longer necessary and should be discarded.

Installation under Asphalt

Position and shape the loop on sub-base. Be sure to use the correct loop size.*

Pull lead-in through 1/2" schedule 40 or 80 rigid PVC. Glue all PVC Joints. If you have a gopher problem lead-in can be run in metallic conduit.

Dig a 2" wide by 3-4" deep trench in the size and place of the loop footprint and lead-in.

Fill the trench with one inch of sand base.

Lay the loop and lead-in run in the trench on top of sand base and use supplied ground stakes to secure the loop corners.

Cover loop and lead-in PVC run with 2 1/2" of sand.

BD Loops cannot come in direct contact with hot asphalt. Call BD Loops for any questions and to find a solution.

Installation in Gravel Road

Position and shape the loop on sub-base. Be sure to use the correct loop size.*

Pull lead-in through 1/2" schedule 40 or 80 rigid PVC. Glue all PVC joints. If you have a gopher problem lead-in can be run in metallic conduit.

Dig a 7" to 10" deep trench in the size and place of the loop footprint and lead-in.

Fill the trench with one inch of sand base.

Lay the loop and lead-in run in the trench on top of sand base and use supplied ground stakes to secure the loop corners.

Cover loop and lead-in PVC run with 2 1/2" of sand. Compact sand around the loop then fill in with road base.

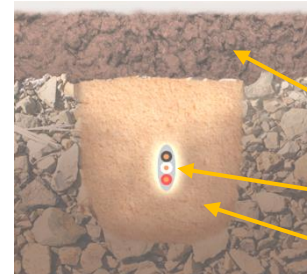

Loop should be encased in sand.

Soil
Loop
Sand

Figure 1

Harness Wire: Solder all connections

Plug/Screw Connectors: Tint all connections

Basic loop layout guidelines to follow

Reverse and Exit Loops

- 4ft from the gate/door.
- Swing gates require 4ft from its complete open and closed position.
- 2ft from each curb.
- 4ft from every other loop.

Shadow loops

- Loop lies under the swing path.
- 3-4ft from the gates in its complete open and closed position.
- 0-2ft from the curb. (Single Swing Gate)

Detection height is determined by approximately 2/3 of the short leg of the loop. Residential 4ft short leg (Detection of standard size vehicles only).

Commercial 6ft short leg (Detect higher bed vehicles).

*Check BDLoops.com for the latest installation instructions

BD Loops 5362 Bolsa Ave. unit C, Huntington Beach, CA 92649

Phone 714 890-1604 ♦ Fax 714 890-1603 ♦ Cell 714 334-6978 ♦ Email bdloops@aol.com

www.BDLoops.com

Installing **BD Loops** in Concrete Over Rebar

When installing **BD Loops** over rebar make sure to follow these simple instructions:

- Determine loop position and lay loop on top of rebar (never below).
- Offset the loop from the rebar pattern (see picture below) then use supplied cable ties to secure loop in place.
- Always run the lead-in underneath the rebar. (see picture below)
- Run the lead-in 6-8" under the concrete form.
- **Run the lead-in in conduit (Schedule 40 or 80 recommended) making sure to glue all PVC joints. If you have a gopher problem lead-in can be run in metallic conduit.**

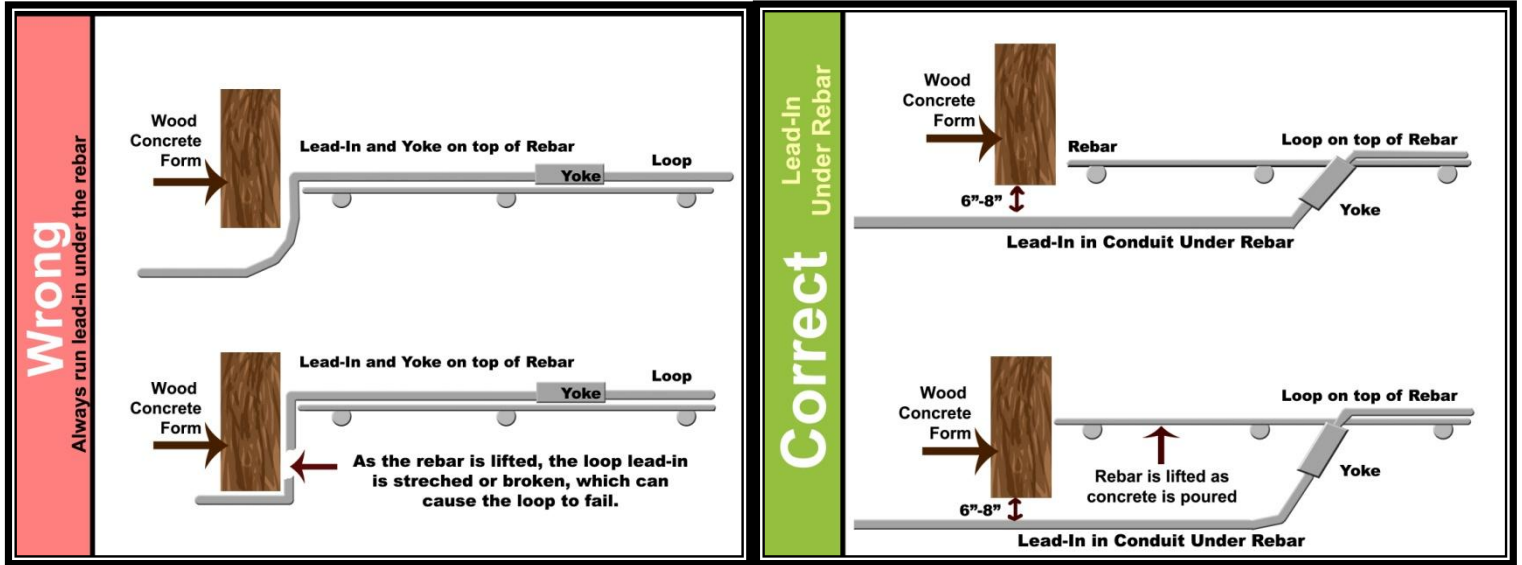

In the picture to the right notice how the "Correct" loop is offset from the rebar pattern. The loop is coming in contact with the rebar as little as possible. ----->

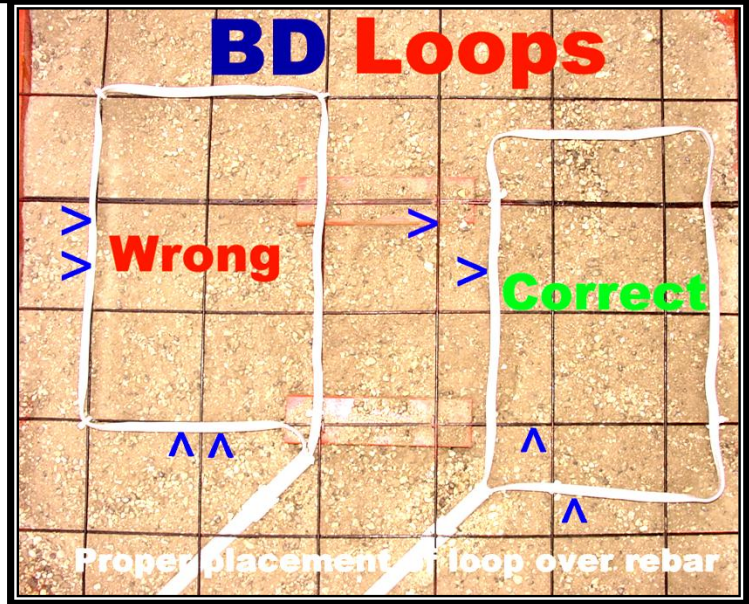

Instrucciones ESPAÑOL

Scan this or visit:

www.bdloops.com/bdloops_downloadsB.html

BD Loops 5362 Bolsa Ave. unit C, Huntington Beach, CA 92649

Phone 714 890-1604 ♦ Fax 714 890-1603 ♦ Cell 714 334-6978 ♦ Email bdloops@aol.com

www.BDLoops.com

